

1

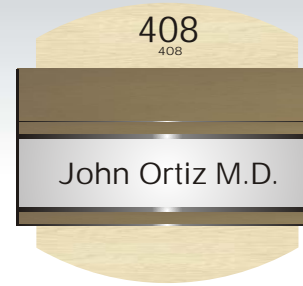

2 w/decorative backer



3 w/decorative backer

Sign Legend

- A. Directory
- B. Directional
- C. Overhead
- D. Evacuation
- E. Stair
- F. Restroom
- G. Misc. Room ID
- H. 6" Room ID
- I. 9" Room ID
- J. Room ID w/changable insert
- K. Room ID w/magnetic window insert
- L. Conference Room
- M. Desk Sign
- N. Workstation ID
- O. Flag Mount
- P. Interior Stairwell

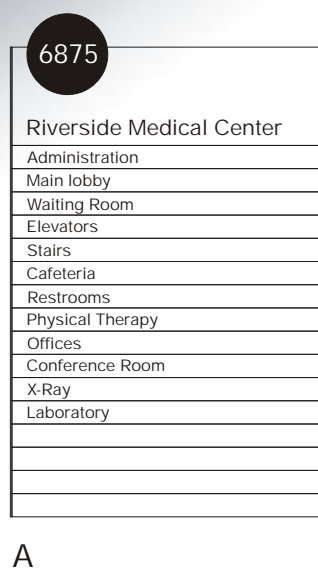

A

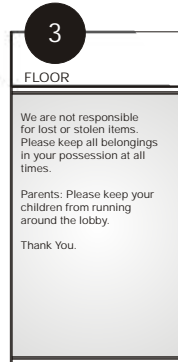

B

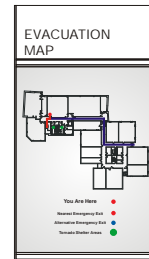

D



C

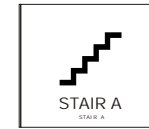

E



F

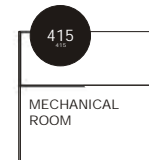

G



H

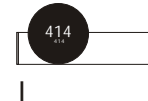

I

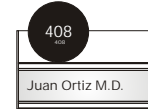

J



K



L



P

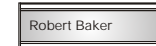

M

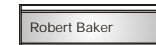

N



O

End Cap Options

Standard End Caps shown on front side
Clip-on, Screw-on, Locking clip

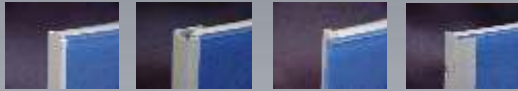

Standard Standard (open end) Flush Facing



SAR SAS BUL QTR

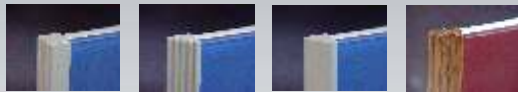

RIB GRD BVL FRM (wood)

Tile Options * Acrylic/Laminate



* Vinyl Graphics Second Surface Graphics Subsurface Graphics Photo Image



* Tactile * Dimensional Second Surface Insert

Facing Options

Literally a tile on a tile

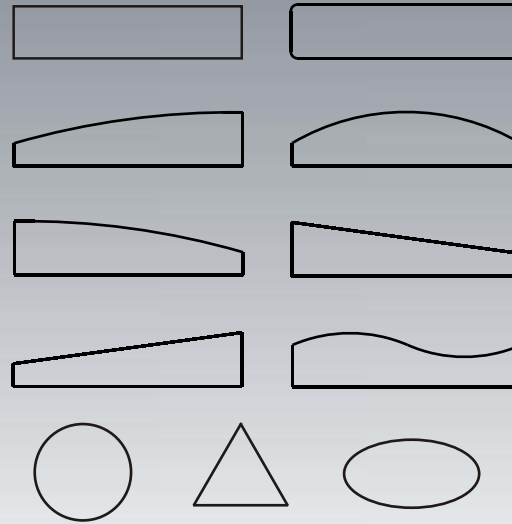

Accent Strips

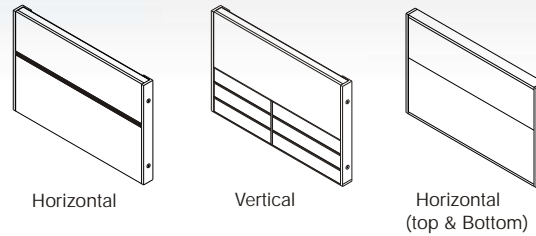

Function

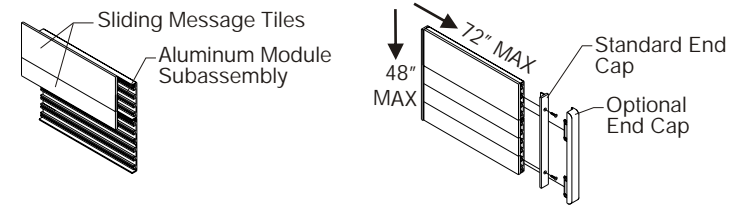

Window Options

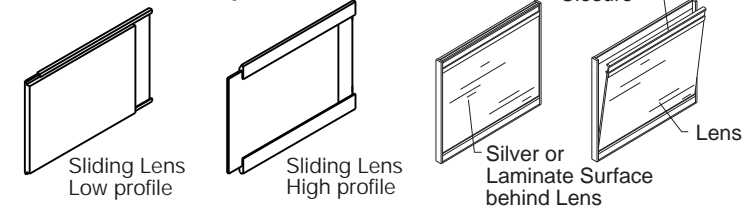

Mounting Options

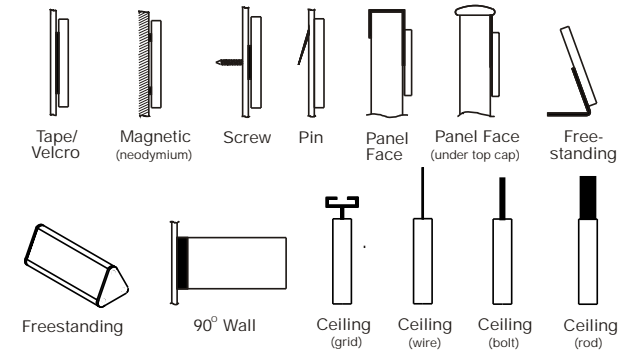

Warranty

Appenx, Inc. warrants its products to be free from defects in material and workmanship from the date of shipment for a period of one year, when the products are installed and used in accordance with the company's published instructions. The Company's obligation and the purchaser's remedy pursuant to the foregoing warranty are limited as follows: to repair or replace, at the Company's option, products which prove to be defective within the warranty period. The Company may request the return of the defective product. Replacement or repaired product will be returned to the purchaser at the Company's expense. Purchasers may be required to establish that the product was installed according to the Company's specifications and that the claim is within the warranty period by producing the invoice for the product or such other evidence as may be reasonably satisfactory to the Company.

Extended Warranty: Appenx, Inc. Warrants the face surface of its Aluminum Group ADA/Tactile tiles not to peel, crack, wear or fade for the life of the product when the products are installed and used in accordance with the Company's published instructions. This warranty is specifically for and limited to the Outsert Aluminum Group, Tactile tiles (A, B, Y & Z series, Aluminum Module, signs; does not include G-Series ADA signs). The Company's obligation and the purchaser's remedy pursuant to the foregoing warranty are limited as follows: to repair or replace, at the Company's option, the tactile tile for the cost of our published, minimum order shipping charge.

The Company will not be held liable for the removal or the installation of the tile(s) under this warranty.

Send to: Appenx, Inc.
Attn: Extended Warranty Dept.
1730 Lincoln Ave.
Holland, MI 49423

THERE ARE NO OTHER WARRANTIES EXCEPT AS EXPRESSLY SET FORTH ABOVE, EITHER EXPRESSED OR IMPLIED.